

Metal clamp for electrical cables

CH

Advantages



- Quick fixing of cable bundles
- Possibility to install different cable diameters at the same time
- Collective bracket for quick installation with BTS6 concrete screw
- Two mounting positions: on ceiling and wall
- Easy extension of cables

Approvals and certificates



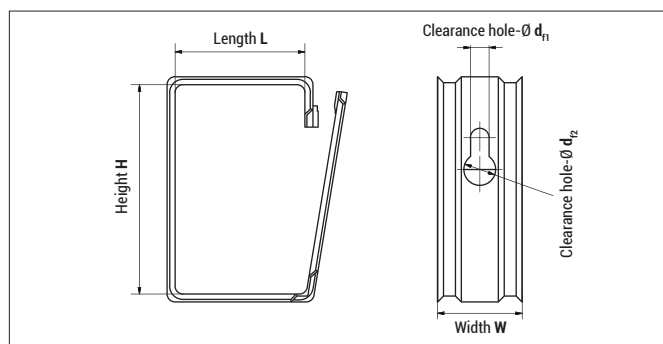

see assessment

Mounting



CH

Type	Art-No	Length L [mm]	Width W [mm]	Height H [mm]	Clearance hole Ø d ₁ [mm]	Clearance hole Ø d ₂ [mm]	€ / 100 pcs	 [pcs]	 [pcs]
CH 63x40x32	94055CH	33,5	32	57	7	12		100	
CH 85x55x32	95580CH	49	32	79	7	12		50	

Recommended loads F_{rec} [kN]

Distance between clamps [mm]	300	400	500	600	700	800
Maximum recommended load per clamp (kg)	≤ 6 ¹⁾	≤ 4,5	≤ 3,6	≤ 3	≤ 2,6	≤ 2,3

¹⁾ The maximum load capacity is 6 kg/m.

It is recommended to install with a spacing of 300 mm to 600 mm, depending on the stiffness of the cable.